

S 2332

∅32 mm, Graphite Brushes, 11 Watt

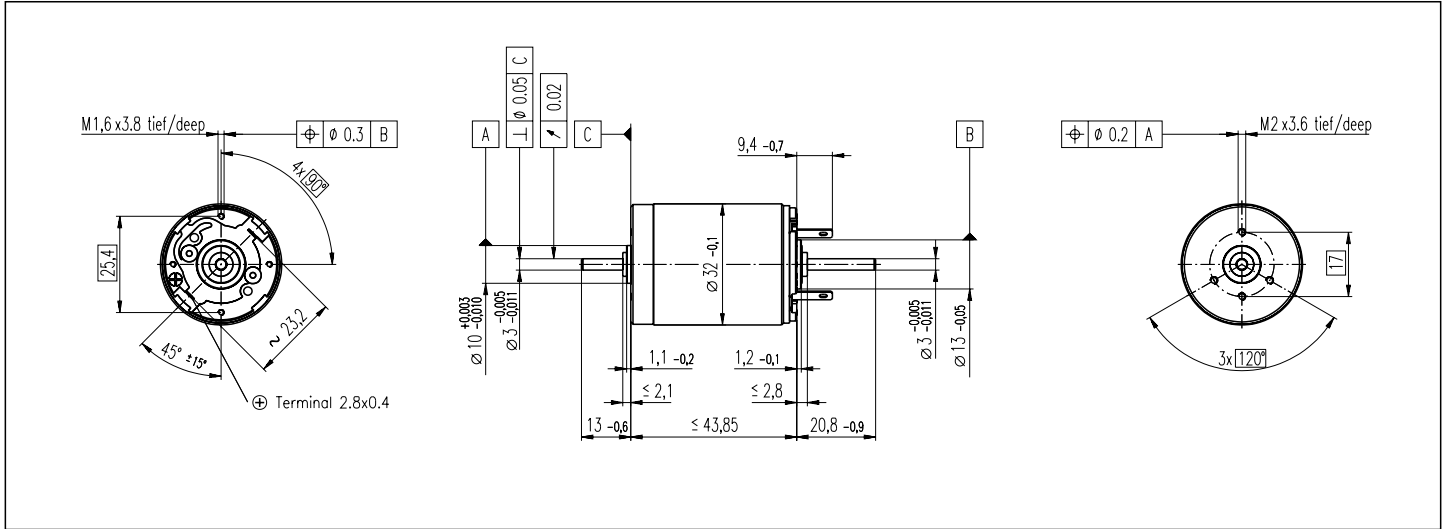

Motor Data: Order Number

		2332. ... -55.276-200 (Insert winding number)									
		Winding number									
		900	904	905	906	908	909	910	911	912	913
1	Assigned power rating	W	11	11	11	11	11	11	11	11	11
2	Nominal voltage	Volt	4.5	9.0	9.0	12.0	18.0	24.0	30.0	36.0	48.0
3	No load speed	rpm	7730	8510	7370	7930	7980	8830	8770	8400	8930
4	Stall torque	mNm	52.3	66.4	58.7	66.2	57.4	74.5	74.7	69.4	74.5
5	Speed/torque gradient	rpm/mNm	176	138	135	126	123	122	120	124	122
6	No load current	mA	160	83	68	55	37	31	25	19	16
7	Starting current	mA	11200	7100	5410	4840	3250	2960	2340	1730	1480
8	Terminal resistance	Ohm	0.403	1.27	1.66	2.48	5.54	8.12	12.8	20.8	32.5
9	Max. permissible speed	rpm	9200	9200	9200	9200	9200	9200	9200	9200	9200
10	Max. continuous current	mA	1500	1500	1500	1280	377	729	585	462	371
11	Max. continuous torque	mNm	7.01	14.0	16.3	17.5	18.2	18.4	18.6	18.5	18.7
12	Max. power output at nominal voltage	mW	8630	13600	10500	13000	13600	16700	16800	15000	17100
13	Max. efficiency	%	60	72	72	75	77	78	79	79	80
14	Torque constant	mNm/A	4.68	9.35	10.8	13.7	20.8	25.2	31.9	40.0	50.4
15	Speed constant	rpm/V	2040	1020	881	698	460	379	300	239	189
16	Mechanical time constant	ms	38	27	27	25	24	23	23	23	22
17	Rotor inertia	gcm <sup>2</sup>	20.9	18.7	18.8	19.0	18.4	18.2	18.1	17.5	17.6
18	Terminal inductance	mH	0.04	0.17	0.22	0.36	0.82	1.21	1.94	3.06	4.85
19	Thermal resistance housing-ambient	K/W	14	14	14	14	14	14	14	14	14
20	Thermal resistance rotor-housing	K/W	2.2	2.2	2.2	2.2	2.2	2.2	2.2	2.2	2.2
21	Thermal time constant winding	s	9	8	8	8	8	8	8	8	8

Operating Range Comments Details on page 36

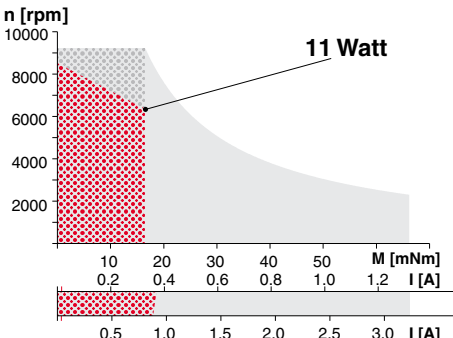

Recommended operating range  
 Continuous operation  
 In observation of above listed thermal resistances (lines 19 and 20) the maximum permissible rotor temperature will be reached during continuous operation at 25°C ambient. = Thermal limit.  
 Short term operation  
 The motor may be briefly overloaded (recurring).  
 912 Motor with high resistance winding  
 908 Motor with low resistance winding

Stock program Standard program Special program (on request!)

- Axial play 0.05 - 0.15 mm
- Max. ball bearing loads
  - axial (dynamic) not preloaded 3.2 N
  - preloaded 2 N
  - radial (5 mm from flange) 16 N
  - Press-fit force (static) 64 N
  - same as above, shaft supported 1200 N
- Radial play ball bearings 0.025 mm
- Ambient temperature range -20/+100°C
- Max. rotor temperature +125°C
- Number of commutator segments 13
- Weight of motor 174 g
- Values listed in the table are nominal. For applicable tolerances (see page 33) and additional details please request our computer printout.
- Options: Our standard program includes ball bearings in place of sleeve bearings and pigtailed in place of solder terminals. Planetary Gearhead 2932.70 . . . see page 216

maxon Modular System

